

RIC-AUX

6 A auxiliary contact bloc with 2 double contacts, 3 different combinations of NO / NC contacts



Type: RIC AUXxx

2 double contacts, 2 NO, 1 NC-1 NO, 2 NC types available

Maximum contact load AC-15	6 A / 230 V, 4 A / 400 V
Recommended minimum contact load	10 mA / 24 V

Contacts

Material	AgNi
Rated operational current AC-15	6 A / 230 V, 4 A / 400 V
Max. switching voltage with RIC 20	400 V

Insulation

Rated insulation voltage	on RIC 20 / 25	440 V
	on RIC 40 / 63	500 V
Rated impulse withstand voltage		4 kV

Specifications

Ambient temperature storage / operation	-30 ... 80 °C / -5 ... 55 °C
Operating frequency at rated load	≤ 600 operations / h
Conductor cross section	Stranded wire 2.5 mm ²
Max. Screw torque	0.8 Nm
Ingress protection degree	IP 20
Weight	50 g

Standard types

2NO	RIC-AUX20
1NO + 1NC	RIC-AUX11
2NC	RIC-AUX02

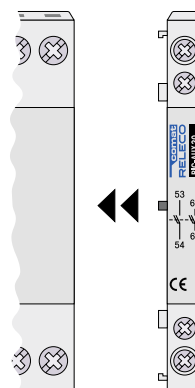

Connection diagram

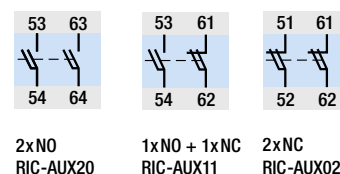

Dimensions [mm]

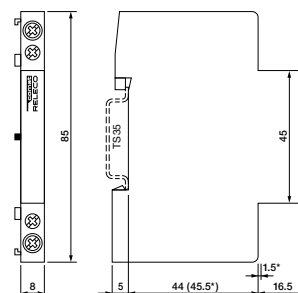

Technical approvals, conformities



IEC/EN 60947-4-1
IEC/EN 60947-5-1
IEC/EN 61095